

TV MOUNTING  
PLATE (x1)

(A)



JOINT(x1)

(B)

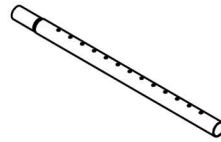

EXTENSION TUBE (x1)

(C)

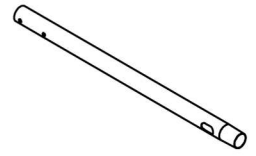

TUBE (x1)

(D)



SUPPORT FRAME (x1)

(E)

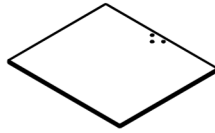

GLASS SHELF (x1)

(F)



FIXED PLATE  
FOR GLASS (x1)

(G)

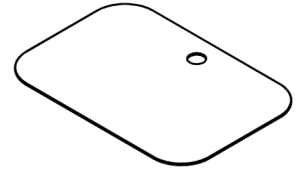

GLASS PLATE (x1)

(H)

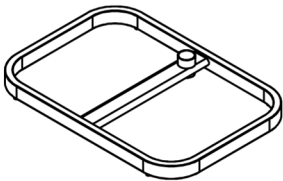

BASE (x1)

(I)



PLASTIC COVER (x1)

(J)



WHEEL (x4)

(K)



PAD (x4)

(L)



FLANGE BOLTS  
1/4\"/>

(1)



SCREW CAP  
5/16\"/>

(2)



SCREW BH 3/8\"/>

(3)



SCREW CSK  
M5\"/>

(4)



WASHER  $\phi$ 9.5\*  
 $\phi$ 45(x1)

(5)



SPRING WASHER  
 $\phi$ 3/8\"/>

(6)



NYLON NUT  
M5(x3)

(7)



WRENCH  
NO.12(x1)

(8)



ALLEN WRENCH  
NO.6(x1)

(9)



ALLEN WRENCH  
NO.4(x1)

(10)

FOR TV

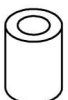

SLEEVE  
 $\phi$ 8.5\* $\phi$ 15\*L20

(11)

# Assembly steps

## STEP 1

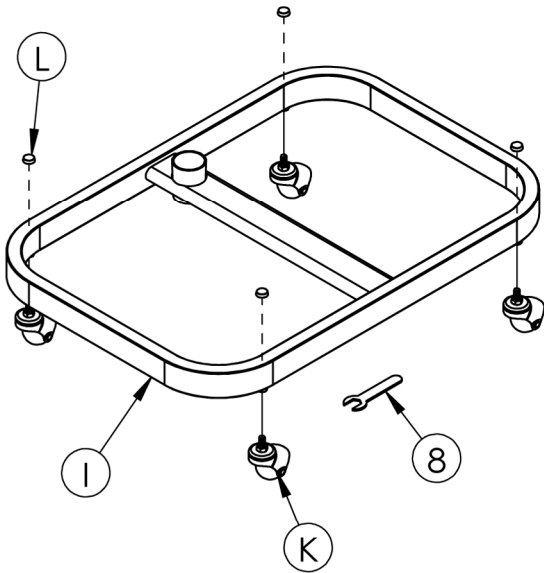

Insert the wheels (K) onto the base (I) with wrench (8) as shown in the step 1.  
Put the pad (L) on the base (I) to protect the glass plate (H).

## STEP 2

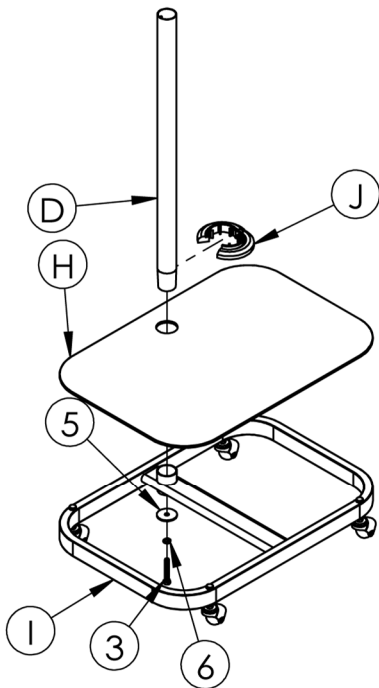

Locate the glass plate (H) on the top of base (I).  
Install the tube (D) through the glass plate (H) and the base (I) with screw (3), spring washer (6) and washer (5).  
Put the plastic cover (J) to cover the tube (D).

## STEP 3

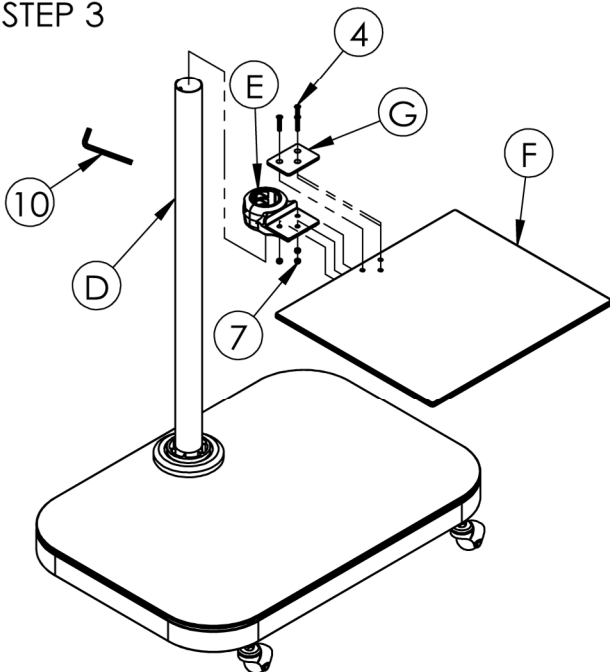

Put the support frame (E) through tube (D).  
Locate the glass shelf (F) and fixed plate on support frame (G) then fix by screw (4) and nut (7).

#### STEP 4

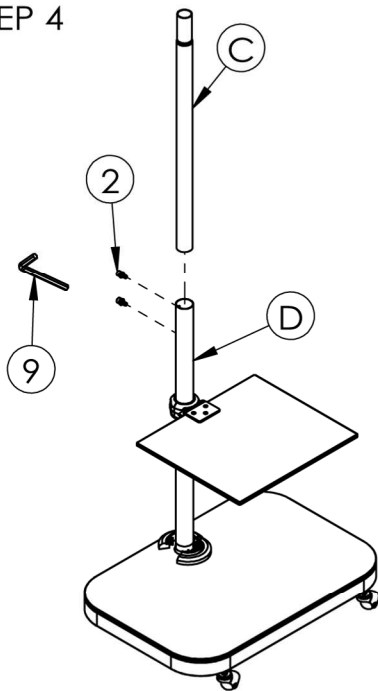

Insert the extension tube (C) and fix by screw (2).

#### STEP 5

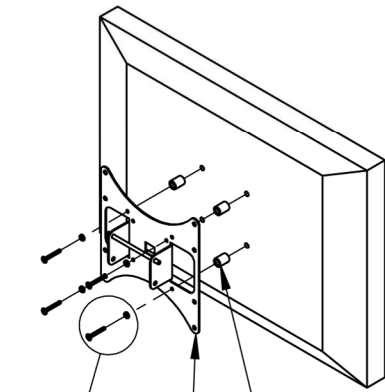

To install the TV mounting plate (B) on the back of TV:  
Locate the mounting screw holes on the back of TV and attached the TV mounting plate (b) with screw (M4 or M5 or M6 or M8) which best fit your TV's mounting holes.

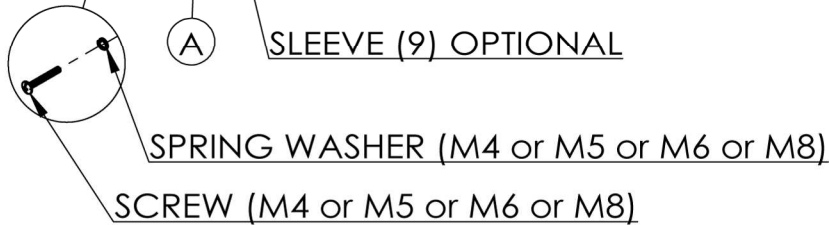
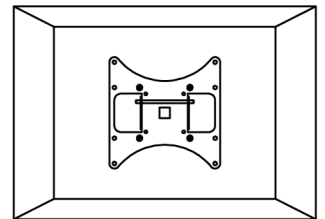

#### STEP 6

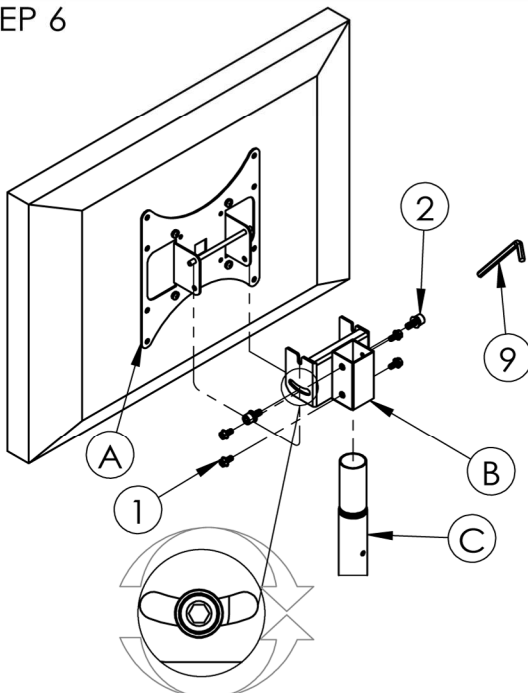

Insert the joint (B) on to the extension tube (C).  
Put the flange bolts (1) on joint (B).  
To fix the TV mounting plate (A) on joint (B) by screw (2).  
Tilting angles could be adjusted from here.