

# Assembly steps

## STEP 1

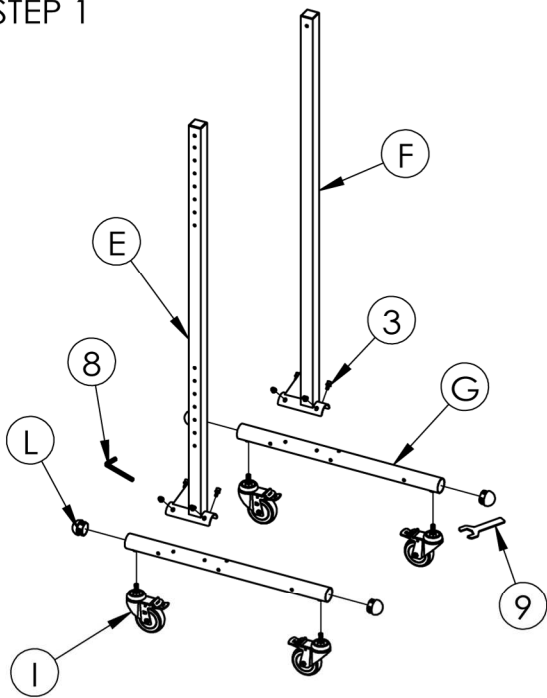

Insert the wheels (I) onto the base tube (G) with wrench (9) as shown in the step 1. Install pillars (E)(F) onto the base tube (G) and fix with the screw (3) .

## STEP 2

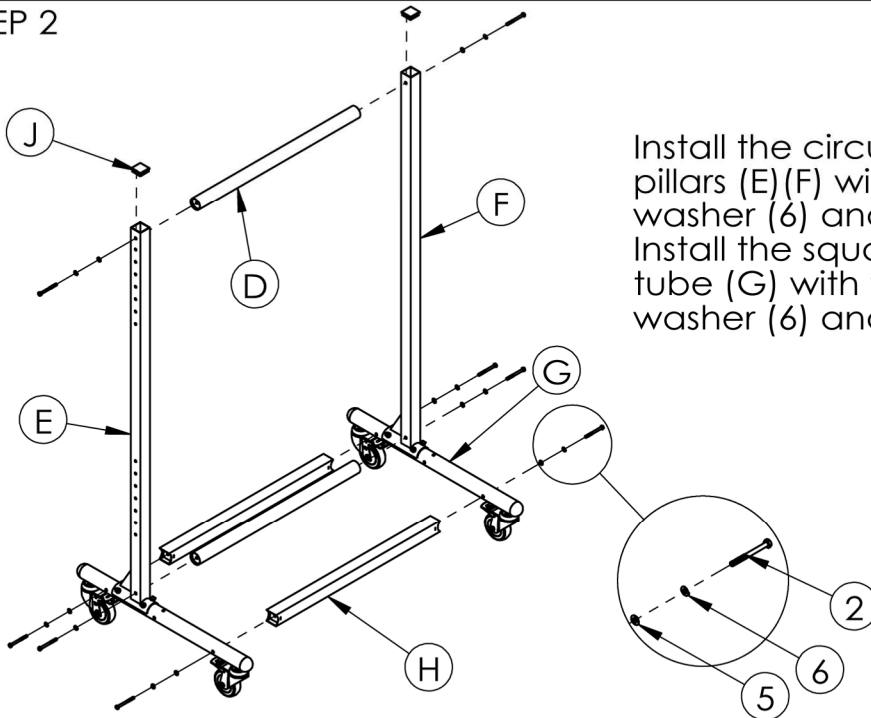

Install the circular beam (D) on to pillars (E)(F) with the washer (5), spring washer (6) and screw (2). Install the square beam (H) on to base tube (G) with the washer (5), spring washer (6) and screw (2).

## STEP 3

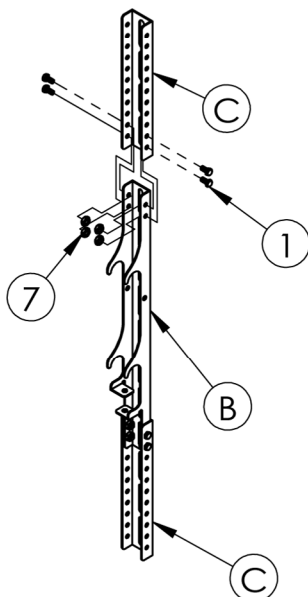

Insert extension plate (C) on to mounting arms(B) with screw (1).

STEP 4

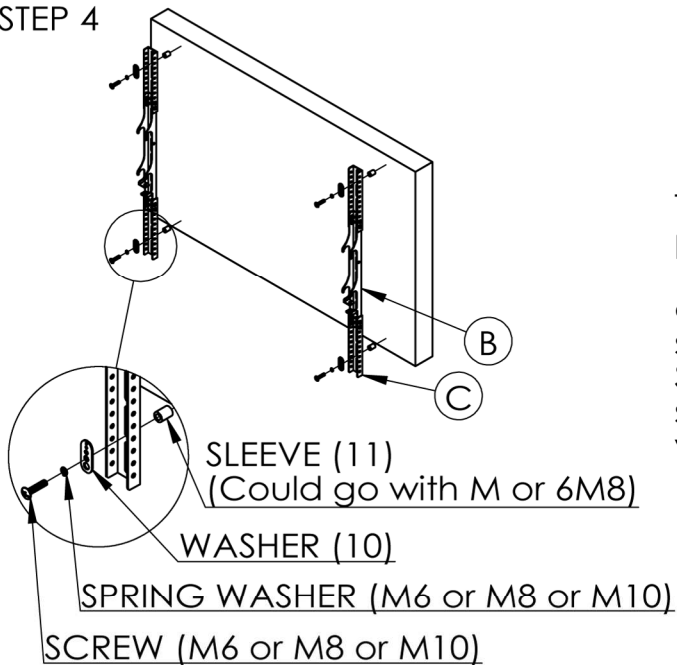

To install Mounting Arms (B) or Extension plate (C) on the back of TV:  
Locate mounting screw fixtures on the back of TV and attached mounting arms (B) with screw (M6 or M8 or M10).  
Select the correct size of screws (M6 or M8 or M10) that match to your TV's the mounting arms (B).

STEP 5

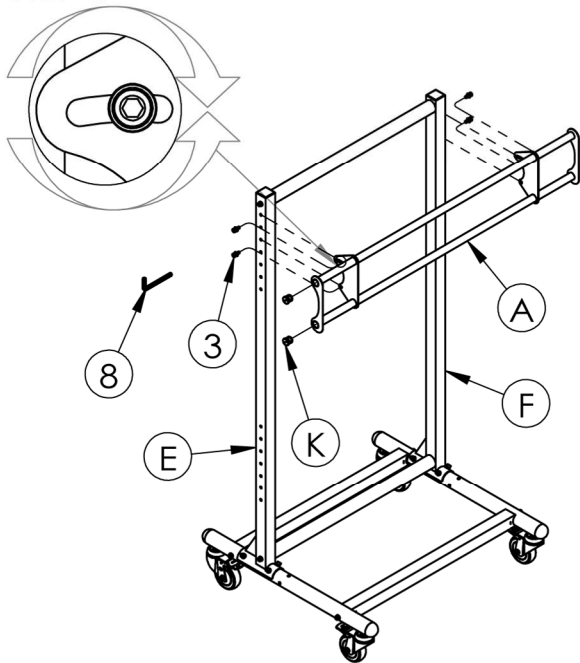

Attach Angle adjustment group (A) on pillars (E) (F) with screw (3).  
Put on plastic cover (K) from both sides of Angle adjustment group (A).

STEP 6

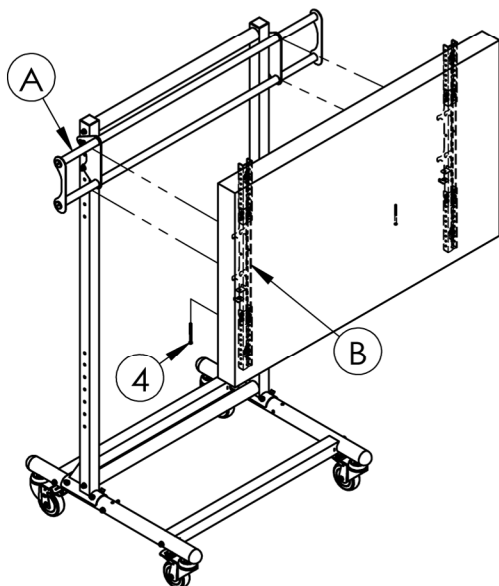

Make sure Mounting arms (B) fixed on the Angle adjustment group (A) by screw (4) well.